

DAMA TV INTEGRATED_SLIDING DOOR

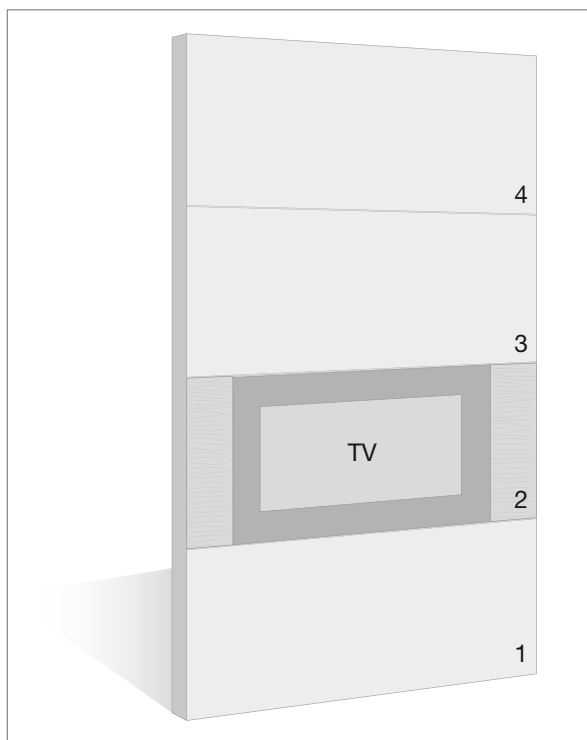
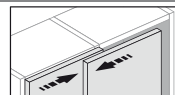

TECHNICAL FEATURES

The Dama TV door is composed of 4 panels available in matt lacquered, gloss lacquered, wood, color wood, gold or silver leaf finishes.

On request it is possible to order different finishes for each of the 4 panels (1-2-3-4).

The panel with a TV set can be fitted in position 2 or 3 only.

To be completed with the integrated television set on page 70.

DOOR INCLUDES SOFT-CLOSE MECHANISM

CROSS-SECTION

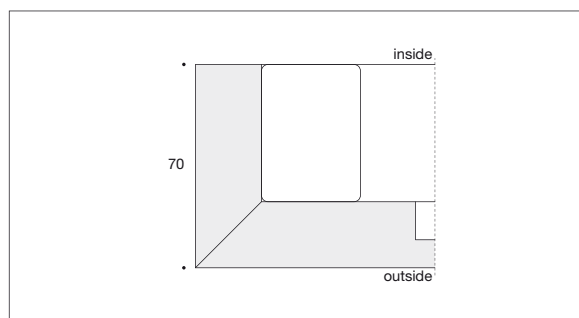

FRONTS



SIDE FRAMES FOR MIRROR PANELS



DOOR DIMENSIONS

DOOR TYPES	H. 2256	H. 2384	H. 2544	H. 2896
Sliding				
W. 770	—	—	—	—
W. 920	—	—	—	—
W. 1020	—	—	—	—
W. 1220	◻	◻	◻	—
W. 1370	◻	◻	◻	—
W. 1520	◻	◻	◻	—

SPECIAL GLASS FOR TV SETS

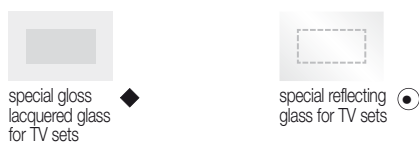

◆ = THE SQUARE INSIDE THE SPECIAL LACQUERED GLASS FOR TV SETS IS BLACK WHEN THE TV IS OFF; NOT AVAILABLE MATT

HANDLES

IT DOESN'T REQUIRE A HANDLE

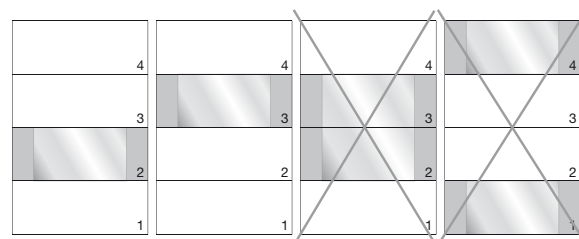

- = NOT AVAILABLE
 - ◻ = PROJECTING DOOR ONLY
- CUSTOM-SIZING IS NOT POSSIBLE

● In the version with reflecting glass, when the TV is off the contours of the screen are barely visible; the led light below the TV indicates the on/stand-by mode and the remote-control receiver.